

# Campus Map

Free valet parking at Green and Yellow entrances.

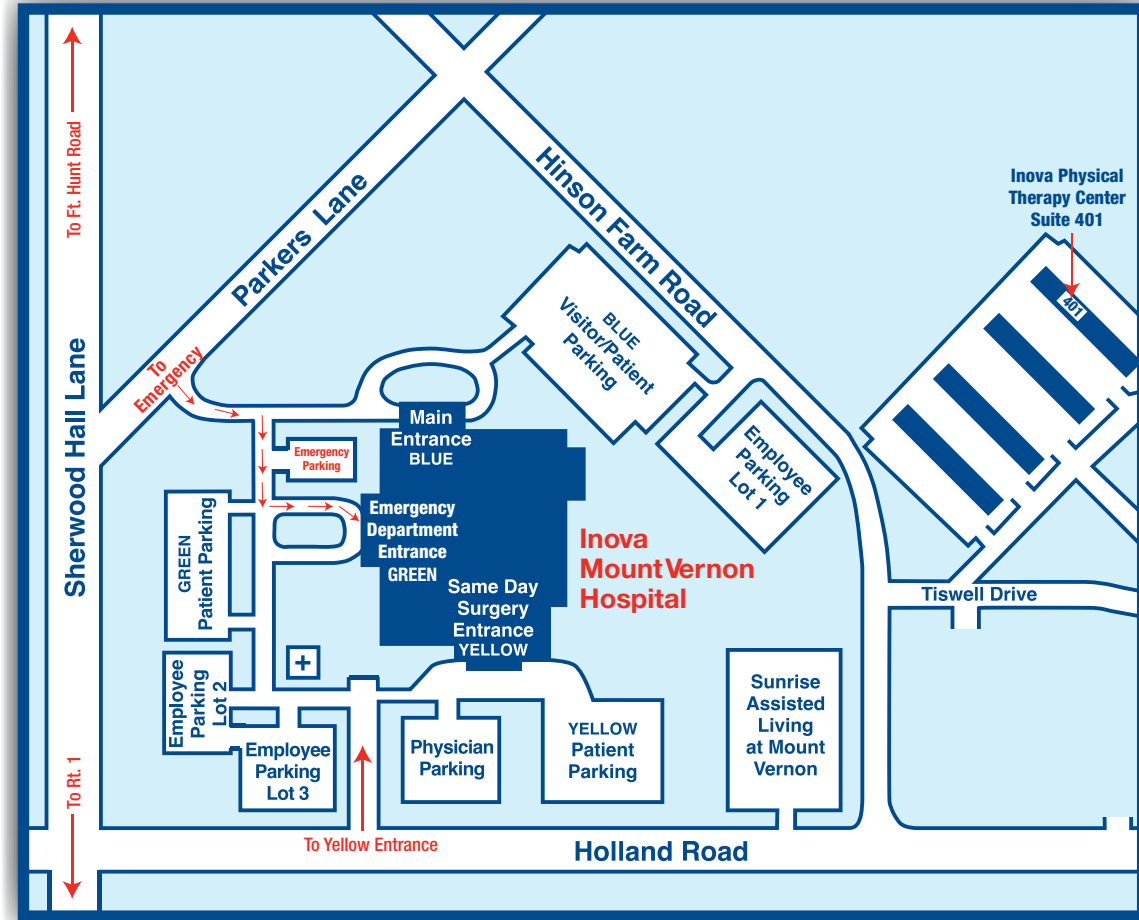

## Useful Numbers

Main Number .....	703-664-7000	Inova Joint Replacement Center .....	703-664-7493
Admitting Office .....	703-664-7023	or .....	1-800-5-REPLACE
Blood Donor Services.....	703-664-7229	Laboratory .....	703-664-7222
Cardiac Health and Rehabilitation.....	703-664-8034	Medical Records.....	703-664-7123
Case Management.....	703-664-7238	Outpatient Rehabilitation Services.....	703-664-7190
Chaplaincy Services.....	703-664-7263	Patient Accounts Customer Service.....	703-321-2999
Diagnostic Imaging .....	703-664-7171	Patient Registration .....	703-664-7023
Emergency Department.....	703-664-7111	Radiology.....	703-664-7171
Hyperbaric Oxygen Therapy Unit.....	703-664-7218	Same Day Surgery .....	703-664-7040
Inova Rehabilitation Center .....	703-664-7592	Surgical Liaison Office .....	703-664-7046
or .....	1-800-554-REHAB	Wound Healing Center .....	703-664-8020

## Inova on the Web

Please visit us at [inova.org](http://inova.org) for more information about Inova Mount Vernon Hospital and see a virtual tour of our hospital.

Inova Health System is a not-for-profit healthcare system based in Northern Virginia that consists of hospitals and other health services, including emergency and urgent care centers, home care, nursing homes, mental health and blood donor services, and wellness classes. Governed by a voluntary board of community members, Inova's mission is to improve the health of the diverse community it serves through excellence in patient care, education and research. Inova provides a healthy environment for its patients, families, visitors, staff and physicians by prohibiting tobacco use on its campuses.

[inova.org](http://inova.org)



## IMVH Directions

### From Virginia Via Route 1

1. Take 95/495 (Capital Beltway – Outer Loop) toward Alexandria/Baltimore
2. Follow signs for 95/495 Local Traffic
3. Take exit 177A-177B for US-1 toward Alexandria/Ft. Belvoir (0.7 mi)
4. Take exit 177A South – Route 1, Ft. Belvoir (0.3 mi)
5. Merge left and travel south on Route 1 (4.0 mi)
6. Turn left at Sherwood Hall Lane (0.5 mi)
7. Turn right at Parkers Lane (0.2 mi)
8. Hospital entrance is on the right

### Via Ft. Hunt Road

1. Follow directions 1 – 4 above
2. Stay right at end of exit and follow signs for Fort Hunt Road (148 ft)
3. Turn left at light and continue onto Fort Hunt Road (2.7 mi)
4. Turn right at Sherwood Hall Lane (1.3 mi)
5. Turn left at Parkers Lane (0.2 mi)
6. Hospital entrance is on the right

### From Alexandria via George Washington Memorial Parkway

1. Take George Washington Memorial Parkway (VA-400) south from Old Town
2. Cross Capital Beltway and continue south (3.0 mi)
3. Turn right on Morningside Lane (0.5 mi)
4. Continue on Sherwood Hall Lane (1.3 mi)
5. Turn left at Parkers Lane (0.2 mi)
6. Hospital entrance is on the right

### From Lorton

1. From Lorton Road turn left at Richmond Highway/Route 1 (7.3 mi)
2. Turn right at Sherwood Hall Lane (0.5 mi)
3. Turn right at Parkers Lane (0.2 mi)
4. Hospital entrance is on the right

### From Woodbridge and points South

1. Merge onto I-95 N via the ramp to Washington
2. Take exit 161 to merge onto Richmond Highway/Route 1 North toward Fort Belvoir/Mt. Vernon (10.2 mi)
3. Turn right at Sherwood Hall Lane (0.5 mi)
4. Turn right at Parkers Lane (0.2 mi)
5. Hospital entrance is on the right

### From Maryland

1. Take 95/495 South (Capital Beltway – Inner Loop) toward Richmond/Alexandria following signs for 95/495 Local Traffic
2. Take exit 177C toward Mount Vernon
3. Turn right at traffic light at end of ramp onto Washington St./George Washington Memorial Parkway/VA-400 South (3.2 mi)
4. Turn right at Morningside Lane (0.5 mi)
5. Continue on Sherwood Hall Lane (1.3 mi)
6. Turn left at Parkers Lane (0.2 mi)
7. Hospital entrance is on the right

# Inova Mount Vernon Hospital

## Campus Map and Directions

2501 Parkers Lane  
Alexandria, VA 22306  
703-664-7000  
[inova.org](http://inova.org)



2501 Parkers Lane  
Alexandria, VA 22306  
703-664-7000

# First Floor

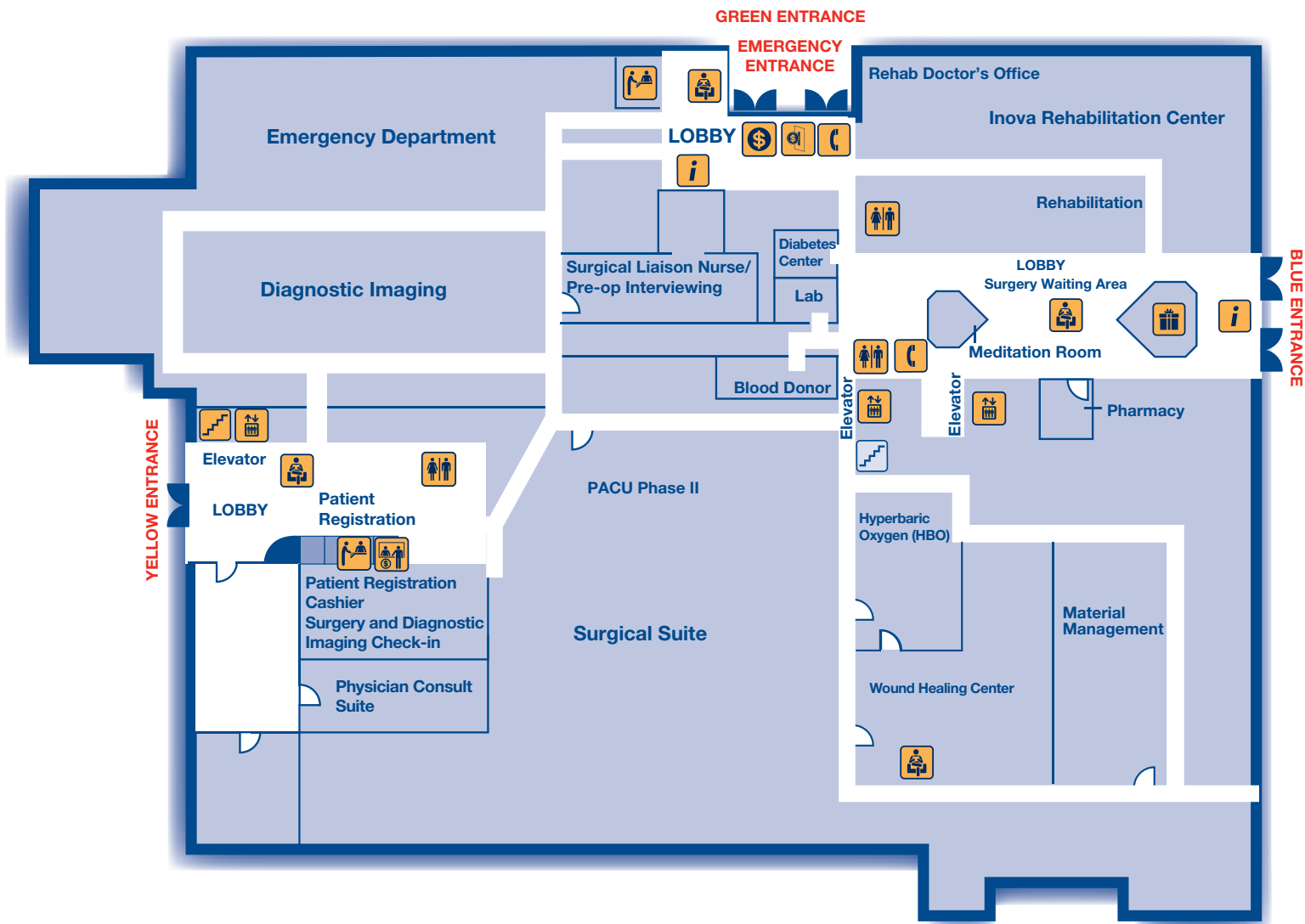

# Second Floor

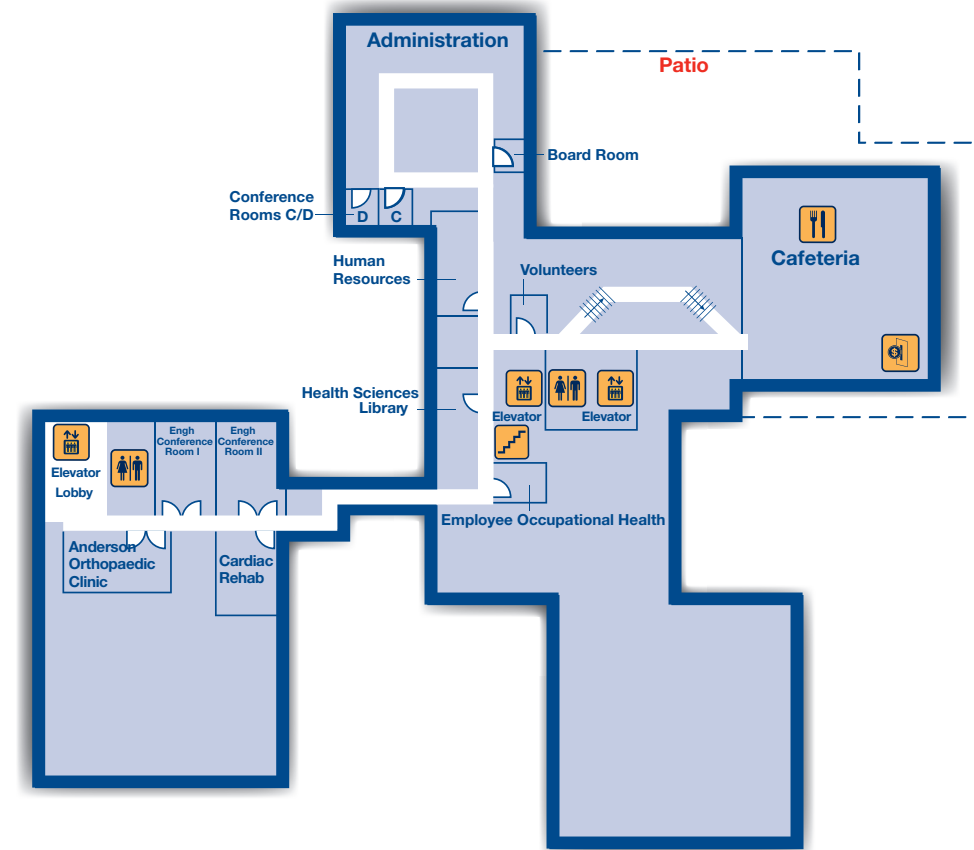

# Third Floor

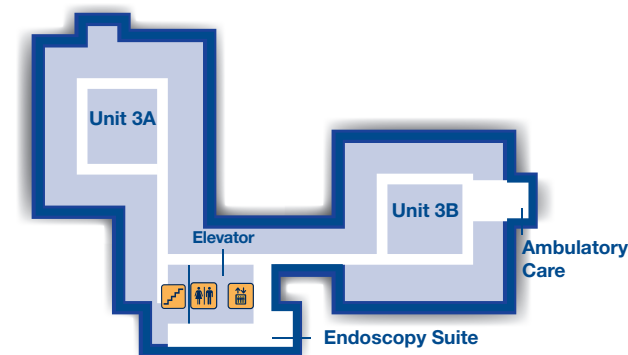

# Fourth Floor

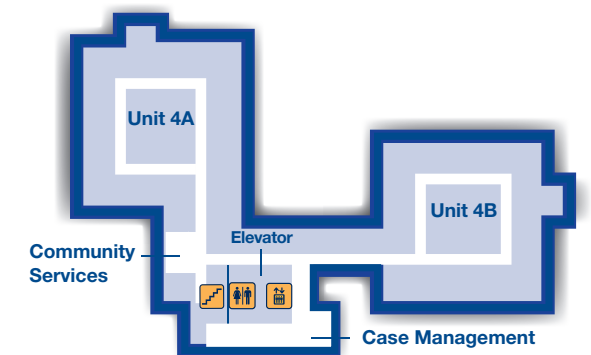

# Fifth Floor

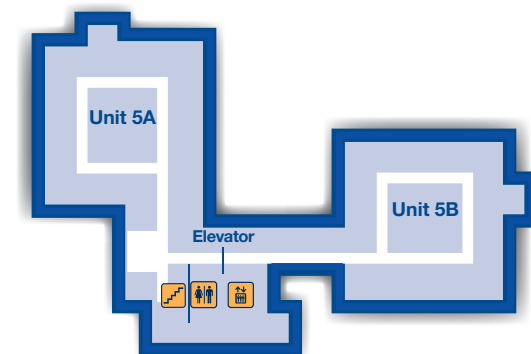

# Sixth Floor

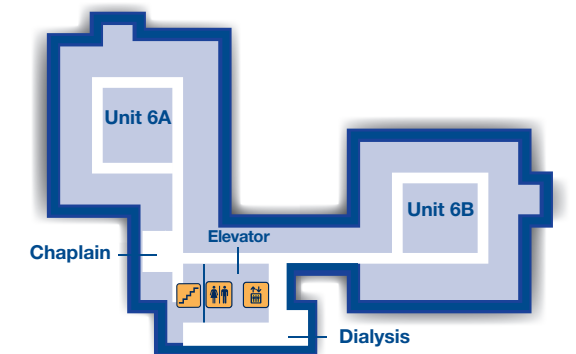

## LEGEND

- |              |           |         |            |                 |              |
|--------------|-----------|---------|------------|-----------------|--------------|
| ATM          | CAFETERIA | CASHIER | ELEVATORS  | GIFT SHOP       | INFORMATION  |
| REGISTRATION | RESTROOM  | STAIRS  | TELEPHONES | VENDING MACHINE | WAITING AREA |