

## First Floor ★ Inova Schar Cancer Institute Outpatient Clinic

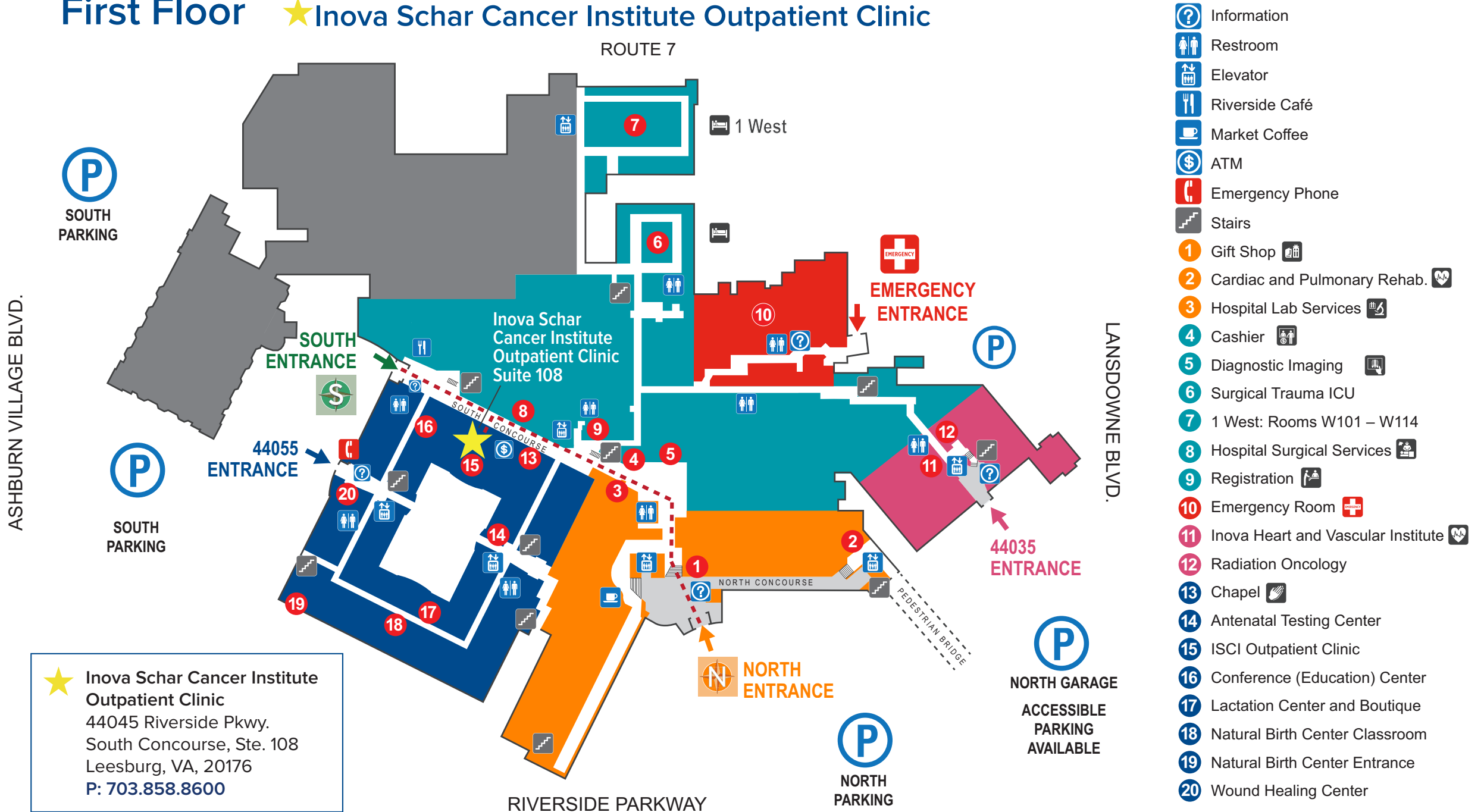

## Second Floor

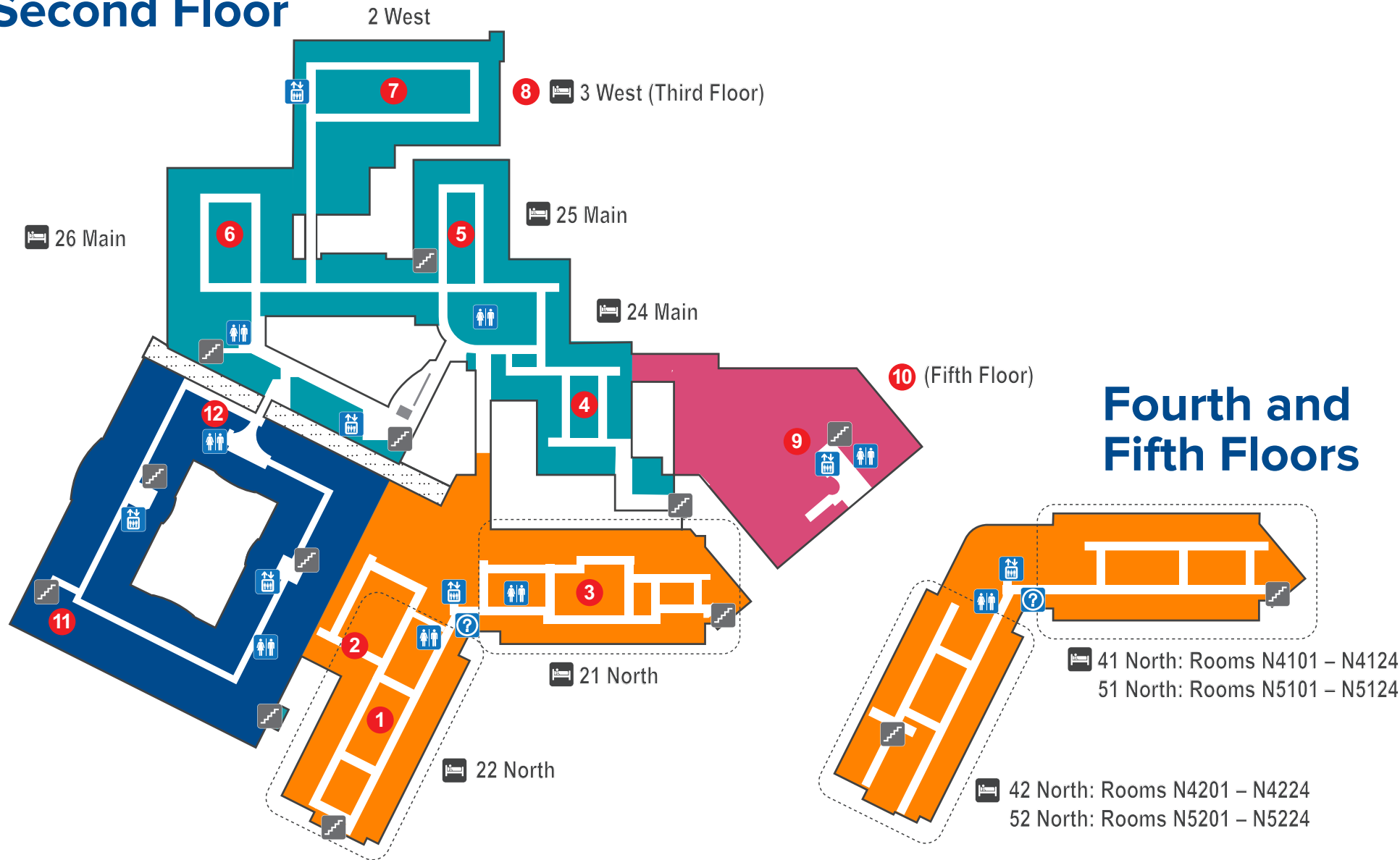

- Information
- Restroom
- Elevator
- Emergency Phone
- Stairs
- 1** 22 North: Labor and Delivery Rooms N2201 – N2216
- 2** 22 North: OB Emergency Dept.
- 3** 21 North: NICU Rooms N2101 – N2116
- 4** 24 Main: Rooms M205 – M230
- 5** 25 Main: Rooms M231 – M245
- 6** 26 Main: Rooms M247 – M274
- 7** Intensive Care Unit (ICU)
- 8** 3 West: Rooms W301 – W314
- 9** Loudoun Ambulatory Surgery Center
- 10** Outpatient Rehabilitation – Fifth Floor
- 11** Inova Cares Clinic for Women
- 12** Hospital Administration